

- NOTE:
- 1) DUE TO THE VARITION IN CHASSIS DESIGNS IT IS THE RESPONSIBILITY OF THE INSTALLER TO INSURE THAT THE CHASSIS MEETS SFI AND/OR SANTIONING BODY RULES, REGUALATIONS AND SPECIFICATIONS.
 - 1) REFER TO THE CONSTRUCTION NOTES AND SFI SPECIFICATIONS FOR FOR COMPONENT LOCATIONS.
 - 2) TUBING HAS BEEN SUPPLIED LONGER THAN REQUIRED TO ALLOW FOR DIFFERENCES IN CHASSIS COFIGURATIONS.
 - 3) REFER TO DRAWING 13-364-2 FOR SECTIONS AND DETAIL VIEWS.
 - 4) ITEM SHOWN IN PHANTOM LINE ARE NOT INCLUDED WITH THIS KIT.

THESE CHASSIS COMPONENTS ARE DESIGNED SPECIFICALLY FOR DRAG RACING. S & W RECOMMENDS CHECKING WITH THE APPROPRIOTE SANCTIONING BODY FOR WELDING REQUIREMENTS AND SPECIFICATIONS.

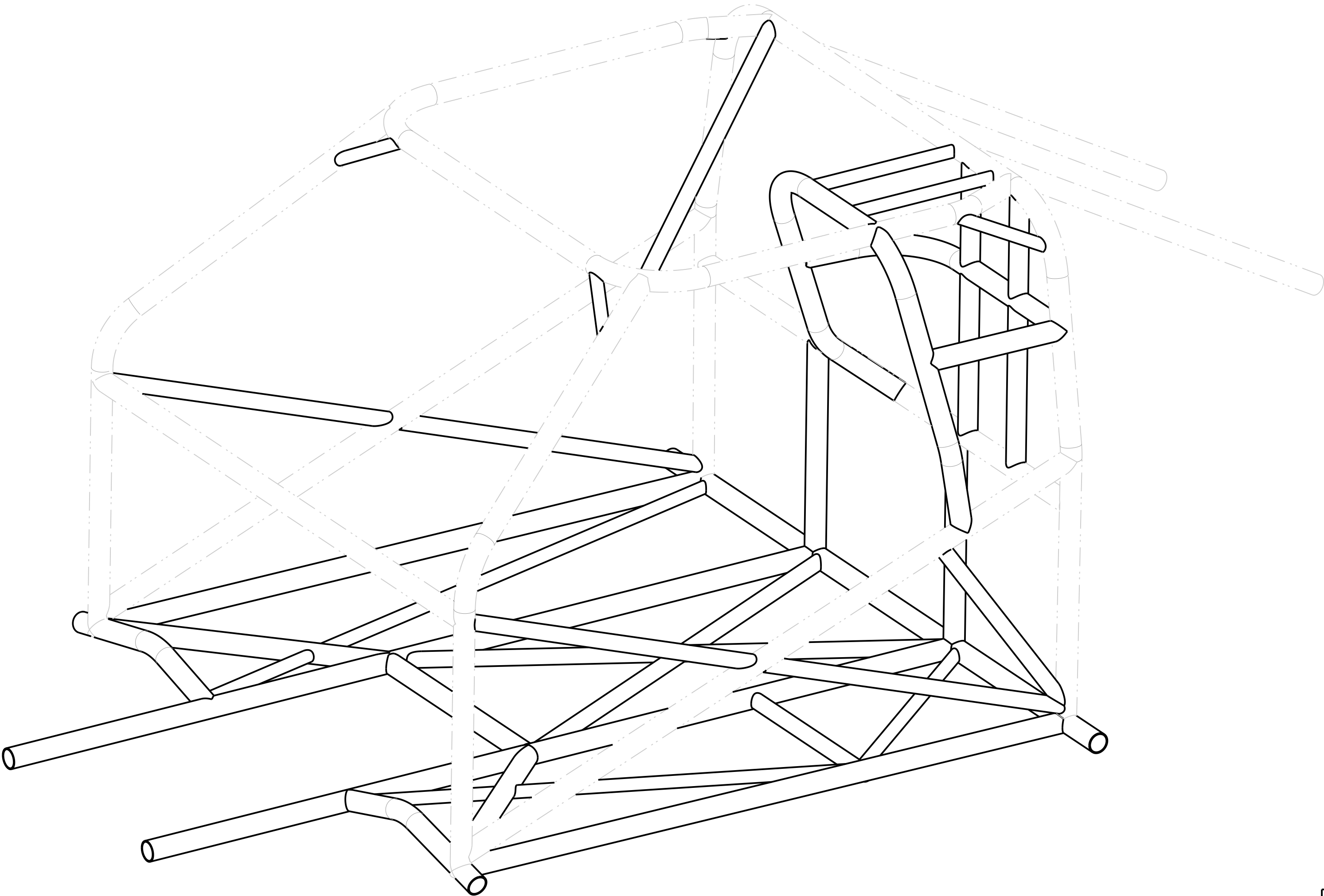

S & W RACE CARS
11 MENNONITE CHURCH RD
SPRING CITY, PA 19475

B	03JUL13	JEB	REVISED F/C CAGE & FLOOR GA
A	22OCT02	JEB	ADD ITEM 20 & 21, REV BOM
0	08FEB00	JEB	INITAIL RELEASE
REV	DATE	DRN	DESCRIPTION
			SFI 25.1 CONVERSION KIT GENERAL ARRANGEMENT DRAWING
PART No: 13-364			Drw No:13-364-1

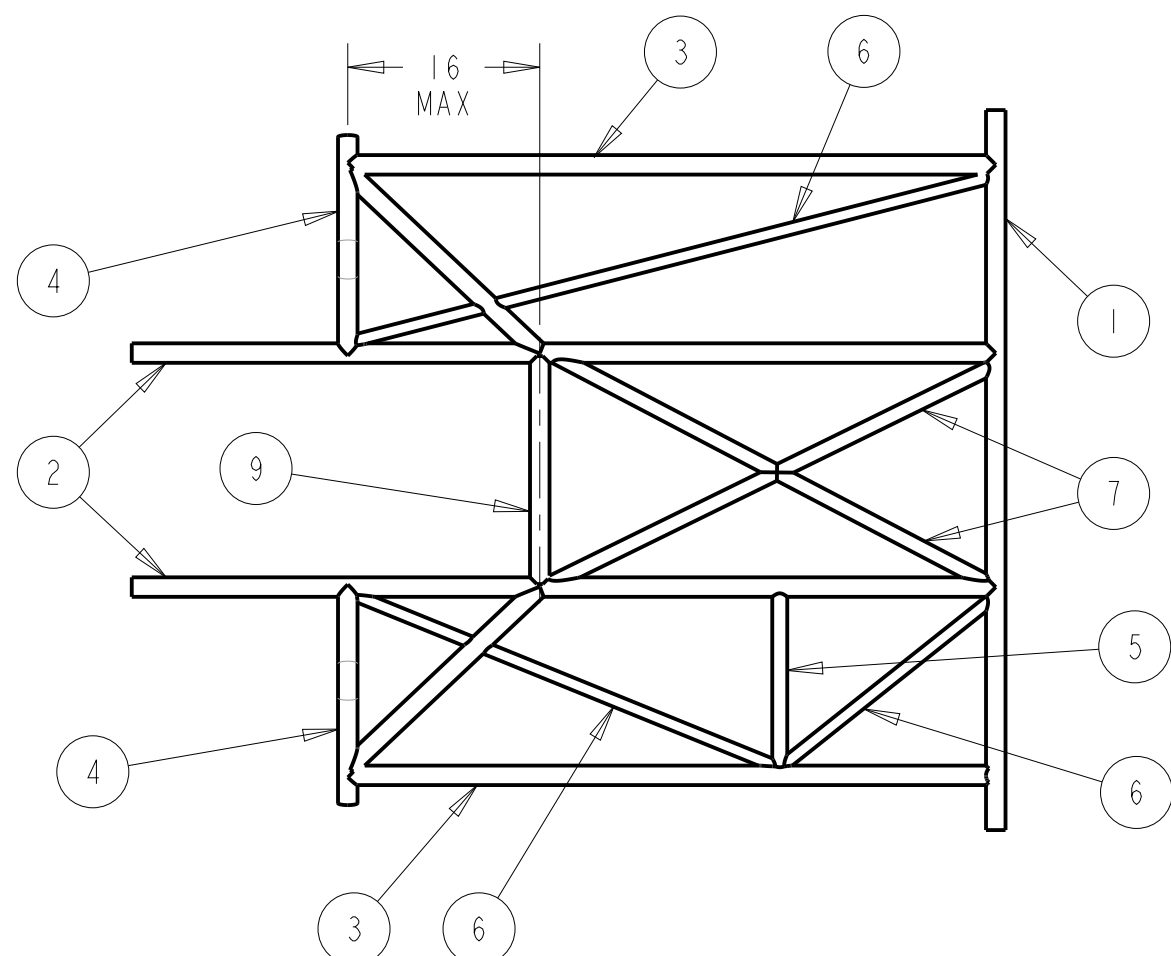

SECTION A-A
SCALE 0.062

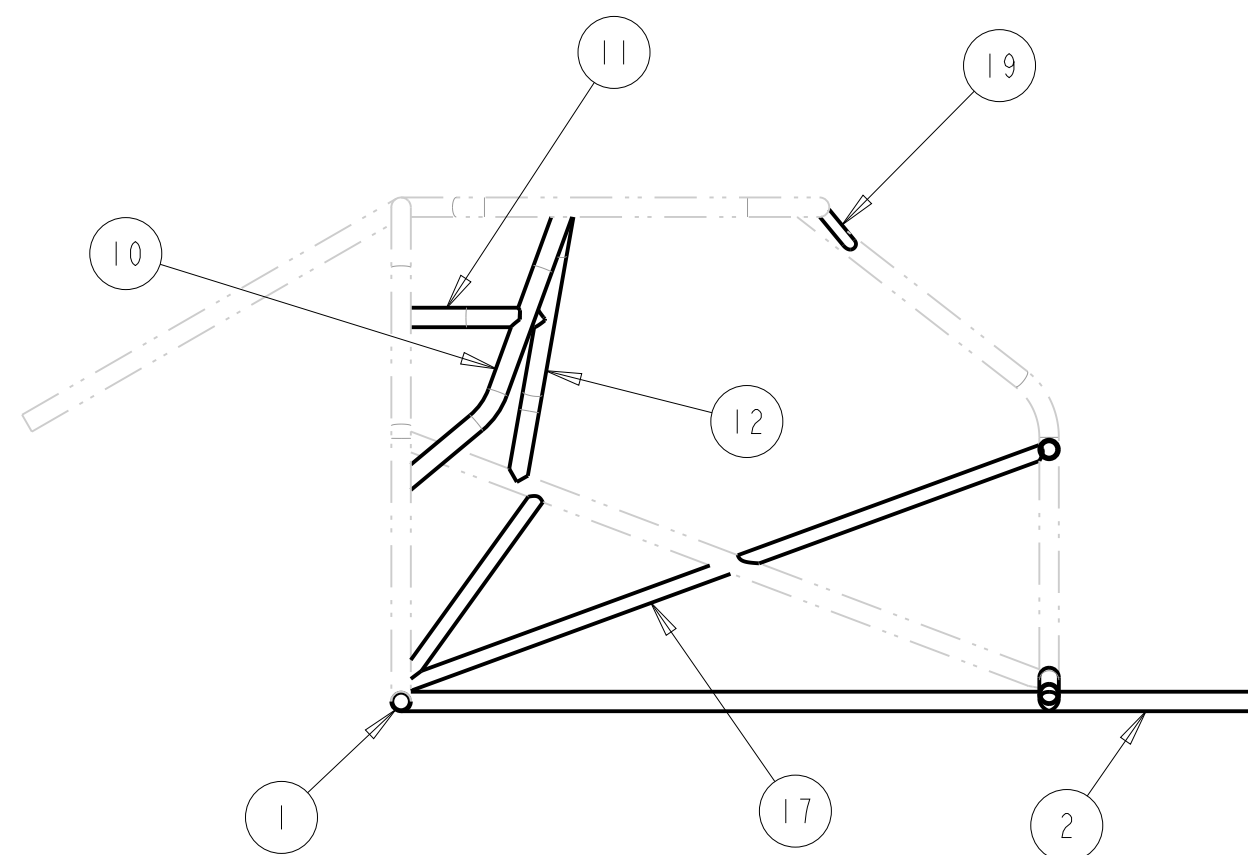
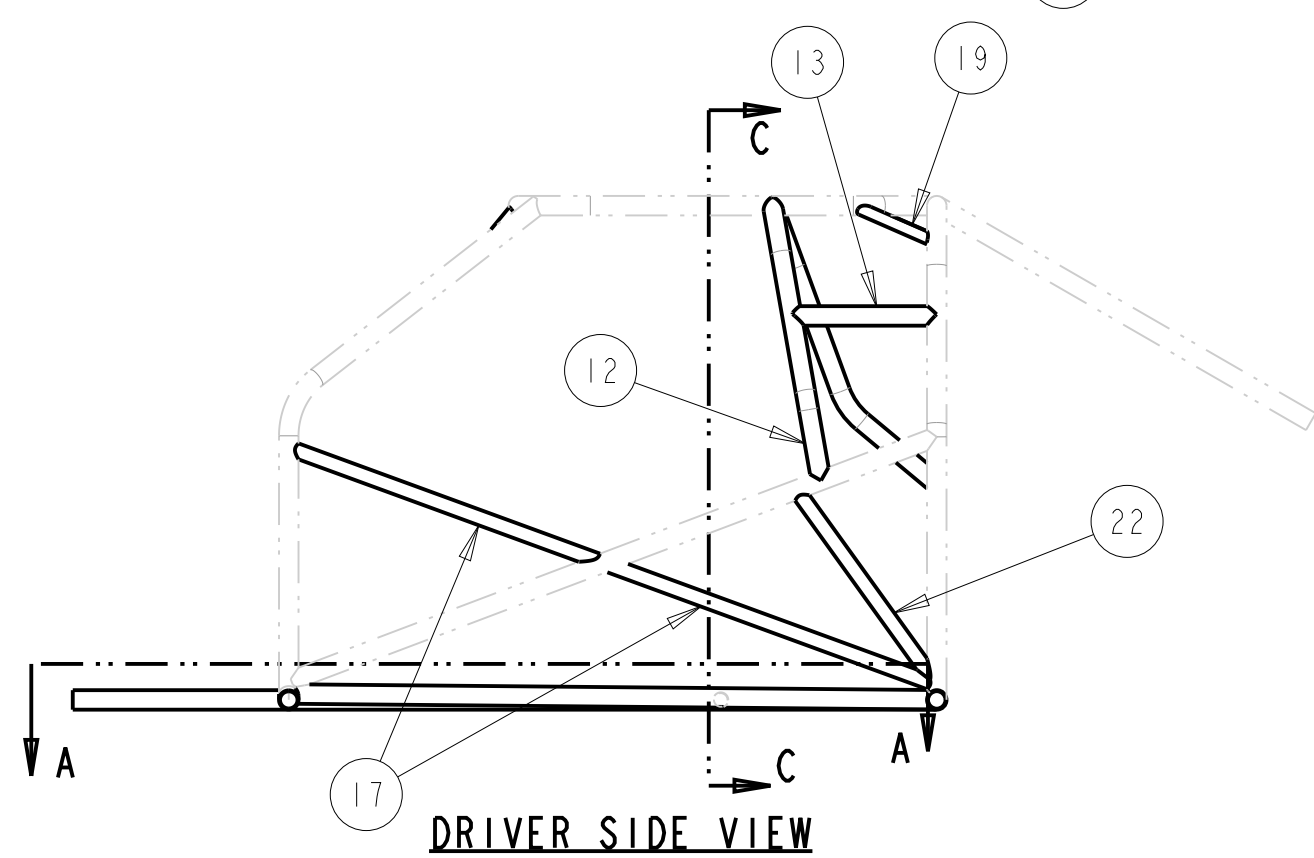
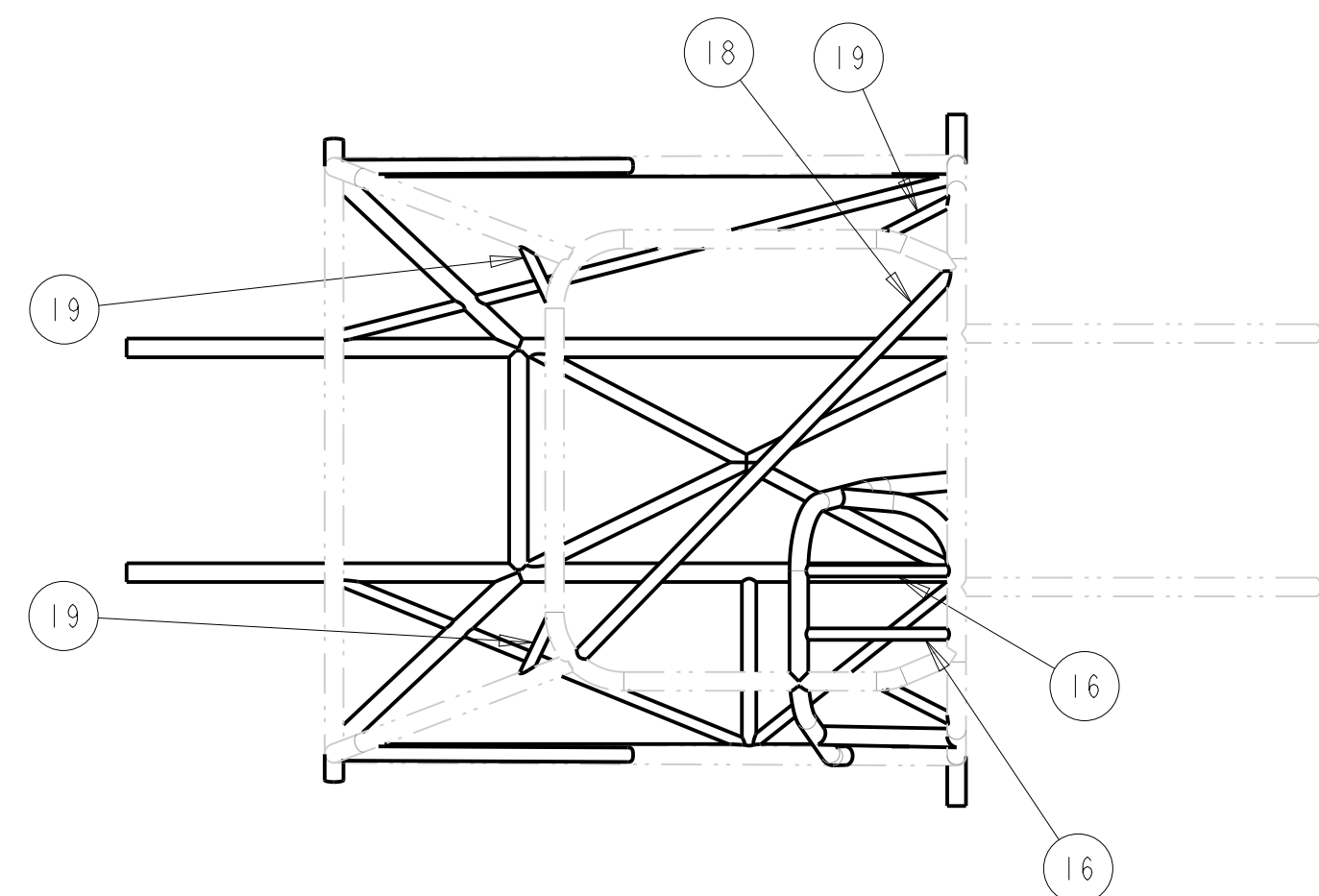

SECTION D-D

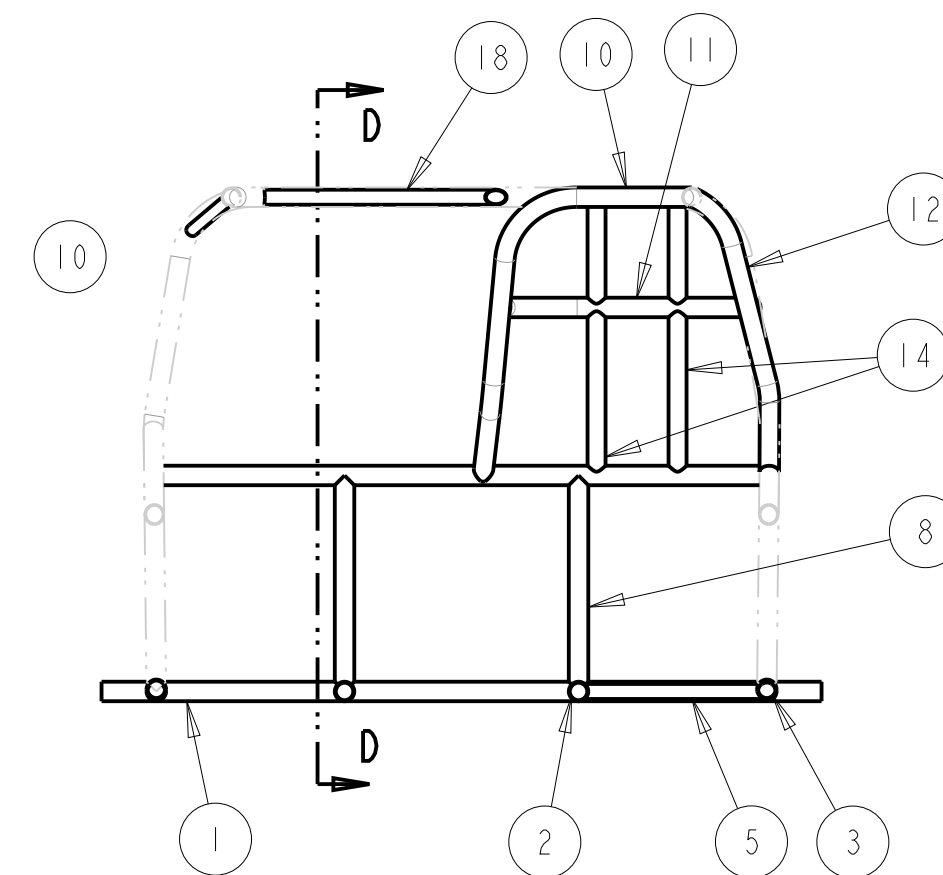

SECTION C-C
SCALE 0.062

- NOTE:**
1) REFER TO THE CONSTRUCTION NOTES AND SFI SPECIFICATIONS FOR COMPONENT LOCATIONS.
2) SOME TUBE ARE NOT SHOWN IN ALL VIEWS.

C	03JUL13	JEB	REV F/C CAGE
B	07JAN04	JEB	ADD ITEM 22, REV FRT OUTRIGGERS
A	22OCT02	JEB	ADD ITEM 20 & 21
0	09FEB00	JEB	INITIAL RELEASE
REV	DATE	DRN	DESCRIPTION
			SFI 25-1E UPGRADE KIT ARRANGEMENT & SECTION VIEWS

S & W RACE CARS
11 MENNONITE CHURCH RD
SPRING CITY, PA 19475

PART No: 13-364

Drw No: 13-364-2